



rammount.com
1.800.497.7479
support@rammount.com

RAM® Brake/Clutch Reservoir Base

Parts Index

* not to scale

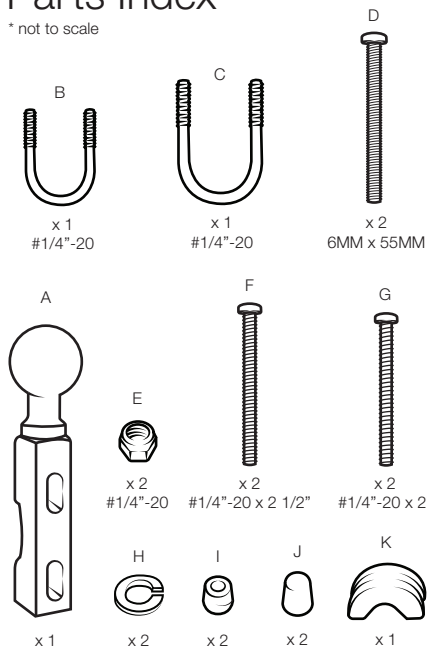

Attach to Brake Reservoir

Preassemble components as shown below. While holding factory clamp assembly in place, remove second factory bolt and replace with RAM® Base with hardware.

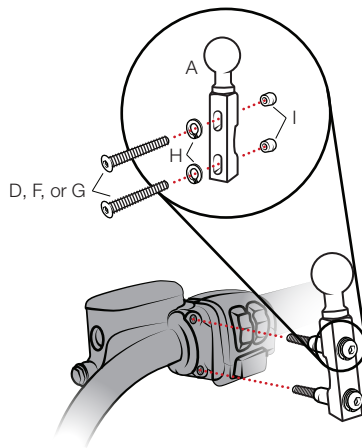

Attach to Handlebar

Preassemble components as shown below. Use the U-bolt hardware and spacer when attaching to bare handlebars.

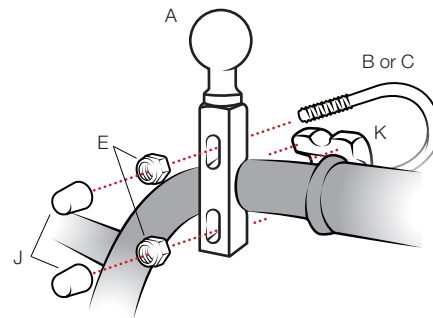

RMR-INS-B-309-7